

THE OAKVIEW

**SAVE UP TO 50%
ON YOUR UTILITIES***

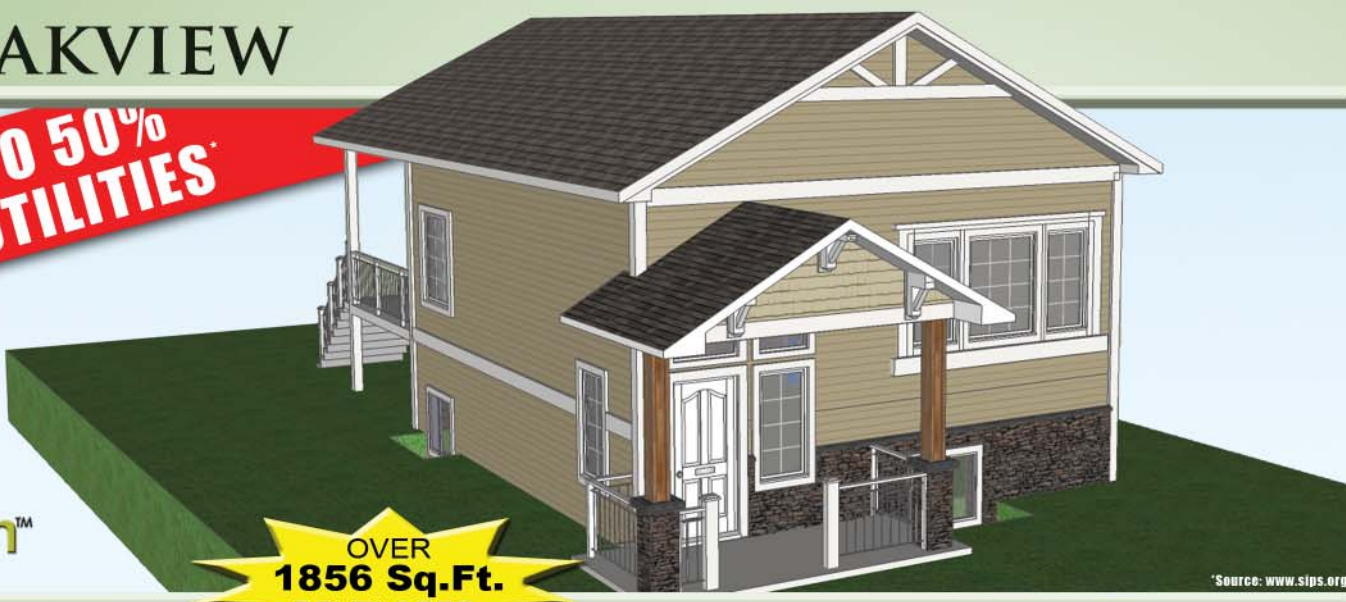

**OVER
1856 Sq.Ft.
DEVELOPED**

*Source: www.sips.org

Unit Features

- 4 Bedrooms + Office/Den
- 2 Bath
- Large Covered Deck
- Covered Front Entry
- Spacious Kitchen /w Island
- Granite Countertops
- Spacious Floor Plan Design
- Metal Railings
- Electric Fireplace (optional)
- Air Conditioned
- Plant Ledges
- Rounded Corners
- And Much More!

Build Green Features

- Hardie Plank/SmartTrim Exterior (Optional)
- Tankless Hot Water
- Insulated Hot Water Lines
- High Efficiency Furnace
- Motorized Fresh Air Inlet
- Low Maintenance Deck Coverings
- EPS Insulation Throughout
- Zero Formaldehyde Insulation
- 25-year Roofing Material
- HRV System
- Mildew and Mold Resistant Materials Used For All External Walls (Optional)
- Energy Efficient Appliances (OPT)

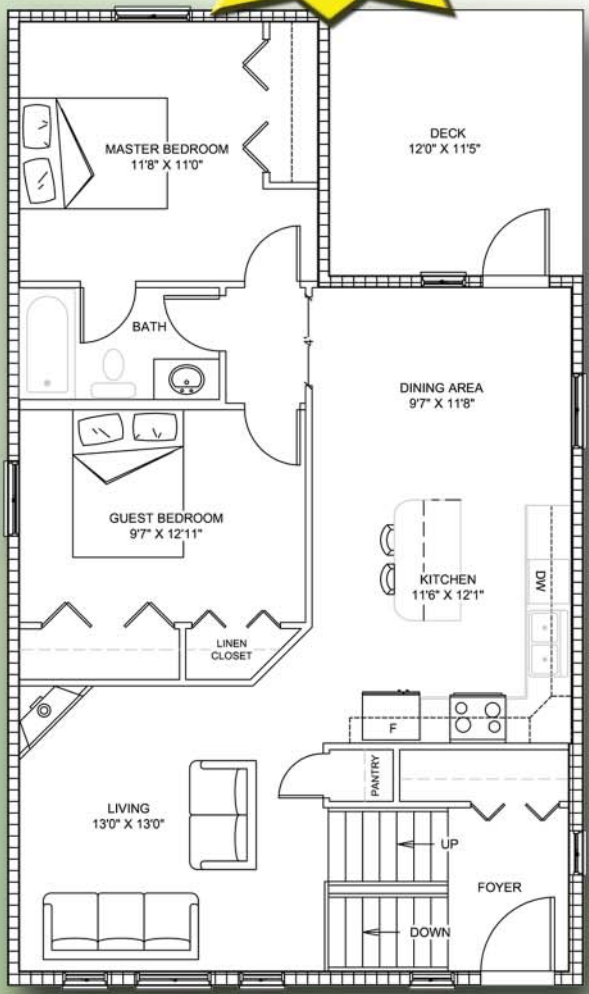

Upper Level

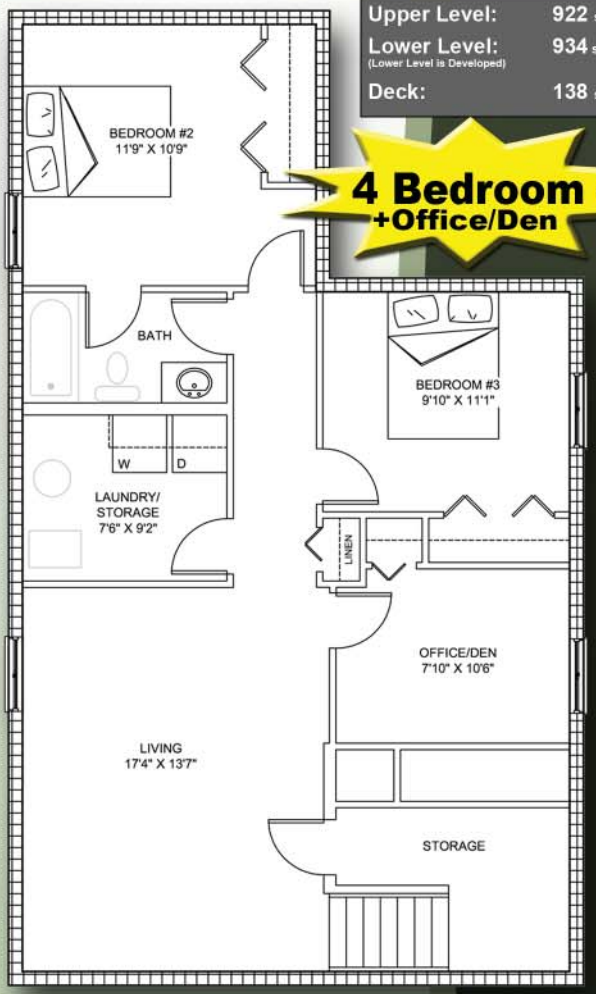

Lower Level

Upper Level:	922 sq.ft.
Lower Level: <small>(Lower Level is Developed)</small>	934 sq.ft.
Deck:	138 sq.ft.

**4 Bedroom
+Office/Den**



CCL
Classic Communities
For More Information Call
(403)529-1023

The Developer reserves the right to make modifications and changes to building and property design, specifications and features; should they be necessary to maintain the high standard and design integrity of this project or to maintain local building code requirements.

WWW.CCLHOMES.COM

At Classic Panels, we are leveraging SIP building technology in the construction of our homes. Structural Insulated Panels (SIPs) are custom-designed prefabricated wall, roof and panels made of a rigid foam core, sandwiched between two structural skins. Advanced fabrication technology allows SIPs to be cut to the design of the home, allowing for quick factory assembly of the home's major components (ie. External/Internal walls, floors, roof, etc). SIP homes are vastly more energy-efficient, stronger, quieter and more draft-free than other building systems such as stud framing with fiberglass insulation. Less air leakage means fewer drafts, less noise, lower energy bills and a much more comfortable indoor environment. The interlocking design of SIPs delivers greatly increased structural performance and resistance to air and moisture intrusion, which increases the life of the home.

To bring the benefits of this building method at an affordable price to the housing market, Classic Panels has developed a system to rapidly build energy efficient homes in components, commonly referred to as panelized construction, out of our Medicine Hat facility. The External and Internal walls, roof, floor and ceiling systems are constructed separately with heating, cooling, plumbing and electrical already installed. They are then shipped as one package to the build site for rapid assembly. On-site, the home is finished as any other, where the walls are drywalled, painted and finishing components such as cabinets, doors, trim, shelving, etc are installed. Classic Panels Ltd. is dedicated to providing you with a high-quality, energy efficient and affordable home.

Combining the quality-control and cost-reductions of a factory assembly model with the benefits of SIP technology, allows Classic Panels Ltd. to bring Built Green Gold* certified homes to the affordable housing market.

* Based on building Green Checklist.



All of our homes are made to exceed the high level of BuiltGreen standards. Some of the BuildGreen features

- SIP superior insulation values, leading to reduced energy bills.
- High-efficiency furnace / tankless hot water
- Minimal waste is generated during construction.
- Insulated water lines.
- Energy-efficient CFL bulbs throughout home.
- Locally-sourced materials whenever available.

Why Panelized Construction?

Material and Cost Savings

- Human error is reduced
- Waste and disposal costs are reduced
- Savings due to volume purchasing
- Materials are optimized using computer software
- Jobsite labour is dramatically reduced
- Less building materials available for theft

Higher Quality Standards

- Factory controlled conditions result in panels that are more accurate and better fitting on-site
- Reduced warping, shrinkage and floor squeaks due to quicker close-in
- Our Panelized process uses premium grade lumber and materials
- Panels are built by experienced workers using the latest computer software, resulting in a consistent and uniform product

Reduced Construction Time

- More reliable completion schedule and move-in date
- Construction loan and interest charges are reduced due to a quicker completion time
- Delays due to material shortages and labour scheduling are reduced
- Construction becomes more feasible year-round

Phase One

Construction of Panel Systems in House Prepare for transport.

PHASE ONE



Phase Two

Assembling of Panels and Construction on site.

PHASE TWO



Phase Three

Finished Product. Turn Keys over to New Homeowner to ENJOY!

PHASE THREE



**For More Information
Call our sales office at
(403) 529-1023**

WWW.CCLHOMES.COM